

JH-351N-4FB



Product feature

- 1. 4 channel Digital chip with noise reduction/WDRC/AFC and help users to hear with maximum clarity
- 2. USB direct charging
 - Without charging case, can work 30H after 2.5 hours' charging
- 3. Flexibility & user-friendly
 - Provide two kinds of sound tubes (left and right) and 3 open fit ear plugs, slim sound tube suitable for people who wear glasses, fit either of the ears.
- 4. Easy operation
 - Press the key to turn on and off the device, rocker switch to adjust the volume, more adapt to the operation habits of the elderly.
- 5. 4 Different Hearing Profiles (programs)
- 6. Knowles Microphone

Technical Data	IEC 60118-7:2005 Test Data (2cc-coupler)	ANSI S3.22-2003 Test Data (2cc-coupler)
Operating Voltage	DC 3.0V~4.25V	DC 3.0V~4.25V
Acoustic Gain (50 dB SPL)		
HFA	33.6dB	32.3dB
1600Hz	31dB	30dB
Peak Value	42.2dB	N/A
Max. output		
HFA	113.8dB	115.1dB
1600Hz	105dB	103dB
Peak Value	121.8dB	123.6dB
Reference Test Gain	31.5dB	34.1dB
Induction Coil Sensitivity	/	/
Frequency Range	267Hz~5645Hz	270Hz~5362Hz
Total Harmonic Distortion (500/800/1600Hz)	0.4%/0.5%/0.2%	0.6%/0.3%/0.2%
Equivalent Input Noise	15dB	16dB
Battery Current	1.2mA	1.2mA
Battery Type	Lithium battery	Lithium battery
Working Time	30h*3 with charging base	30h*3 with charging base

FITTING RANGE

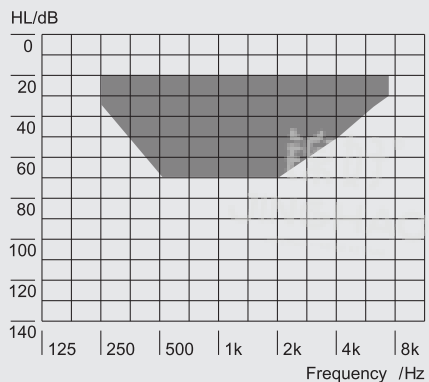

1. Change Hearing Mode(Program)/ (ON/ OFF)
2. Volume Control
3. USB Charging Port
4. Ear Tube
5. Ear Dome
6. Stabilization Bar

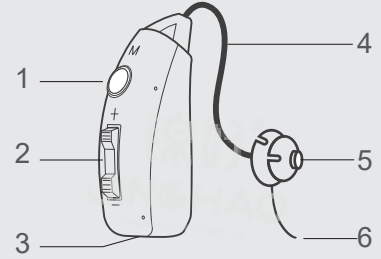

JH-351N-4FB

Accessories



Ear Dome(L)



Ear Dome(M)

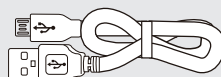

Micro USB Cable



Cleaning Tool

All Curves are measured with fonix 8000 hearing aid test system, 2cc-coupler ,IEC 60118-7.All sound pressure levels are referred to 20 μ Pa (OSPL90 Output/FOG50 Gain/Reference Test Gain(RTG))

OSPL₉₀ Output

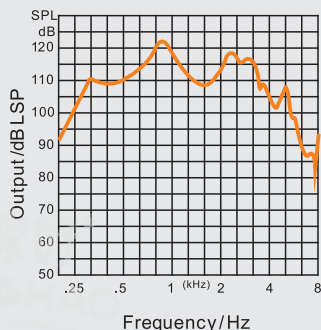

FOG₅₀ Gain

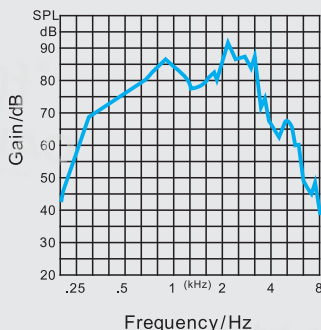

Reference Test Gain (RTG)

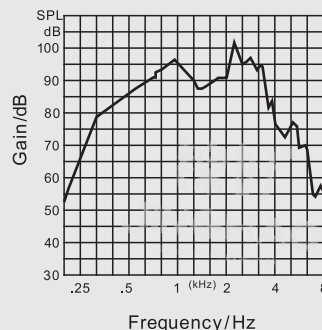

WARNING! Choking hazard posed by small parts.
Infants, small children and persons of mental incapacity
must not wear the hearing instrument
without appropriate supervision.